

[Recent Sales in Neighborhood](#)
[Recent Sales in Area](#)
[Previous Parcel](#)
[Next Parcel](#)
[Field Definitions](#)
[Return to Main Search Page](#)
[Spalding Home](#)

Owner and Parcel Information

Owner Name	RAVEN GROUP LLC	Today's Date	March 2, 2016
Mailing Address	2341 PEACHWOOD CIR NE	Parcel Number	011 03001
	ATLANTA, GA 30345	Tax District	Griffin (District 01)
Location Address	310 N 12TH ST	2015 Millage Rate	43.980
Legal Description	N 12TH ST	Acres	0.82
Property Class(NOTE: Not Zoning Info)	C3-Commercial	Neighborhood	20212
Zoning	PID	Homestead Exemption	No (S0)
Landlot/District	144/02	Parcel Map	Show Parcel Map

2015 Tax Year Value Information

Land Value	Improvement Value	Accessory Value	Total Value	Previous Value
\$ 18,450	\$ 10,303	\$ 2,190	\$ 30,943	\$ 31,315

[Assessment Notice](#)

Land Information

Type	Description	Calculation Method	Acres	Photo
COM	Suburban Small Parcels	Acres	0.82	NA

Improvement Information

Description	Value	Actual Year Built	Effective Year Built	Square Feet	Wall Height	Wall Frames	Exterior Wall
Warehouse - Storage	\$ 10,303	1940	1965	2,664	14		
Roof Cover	Interior Walls	Floor Construction	Floor Finish	Ceiling Finish	Lighting	Heating	Sketch
						014-0	Sketch Building 1 Building Images

Accessory Information

Description	Year Built	Dimensions/Units	Value
Fence - Wood Show Photo	0	6x450 0	\$ 1,490
Carport - Prefab Show Photo	0	16x26 0	\$ 700

Sale Information

Sale Date	Deed Book / Page	Plat Book / Page	Sale Price	Reason	Grantor	Grantee
04/18/2006	2931 68		\$ 0	NON FAIR MARKET VALUE	NEWTON WILL HILL JR	RAVEN GROUP LLC
12/28/1950	127 69		\$ 0	NON FAIR MARKET VALUE		NEWTON WILL HILL JR

Permit Information

Permit Date	Permit Number	Type	Description
08-19-2009	09.0593	OUTBUILDING	
11-12-2008	08.1263	DEMOLITION	

[Recent Sales in Neighborhood](#)
[Recent Sales in Area](#)
[Previous Parcel](#)
[Next Parcel](#)
[Field Definitions](#)
[Return to Main Search Page](#)
[Spalding Home](#)

The Assessor's Office makes every effort to produce the most accurate information possible. No warranties, expressed or implied, are provided for the data herein, its use or interpretation. The assessment information is from the last certified tax roll. All data is subject to change before the next certified tax roll. Website Updated: February 23, 2016

© 2005 by the County of Spalding, GA | Website design by [qpublic.net](#)

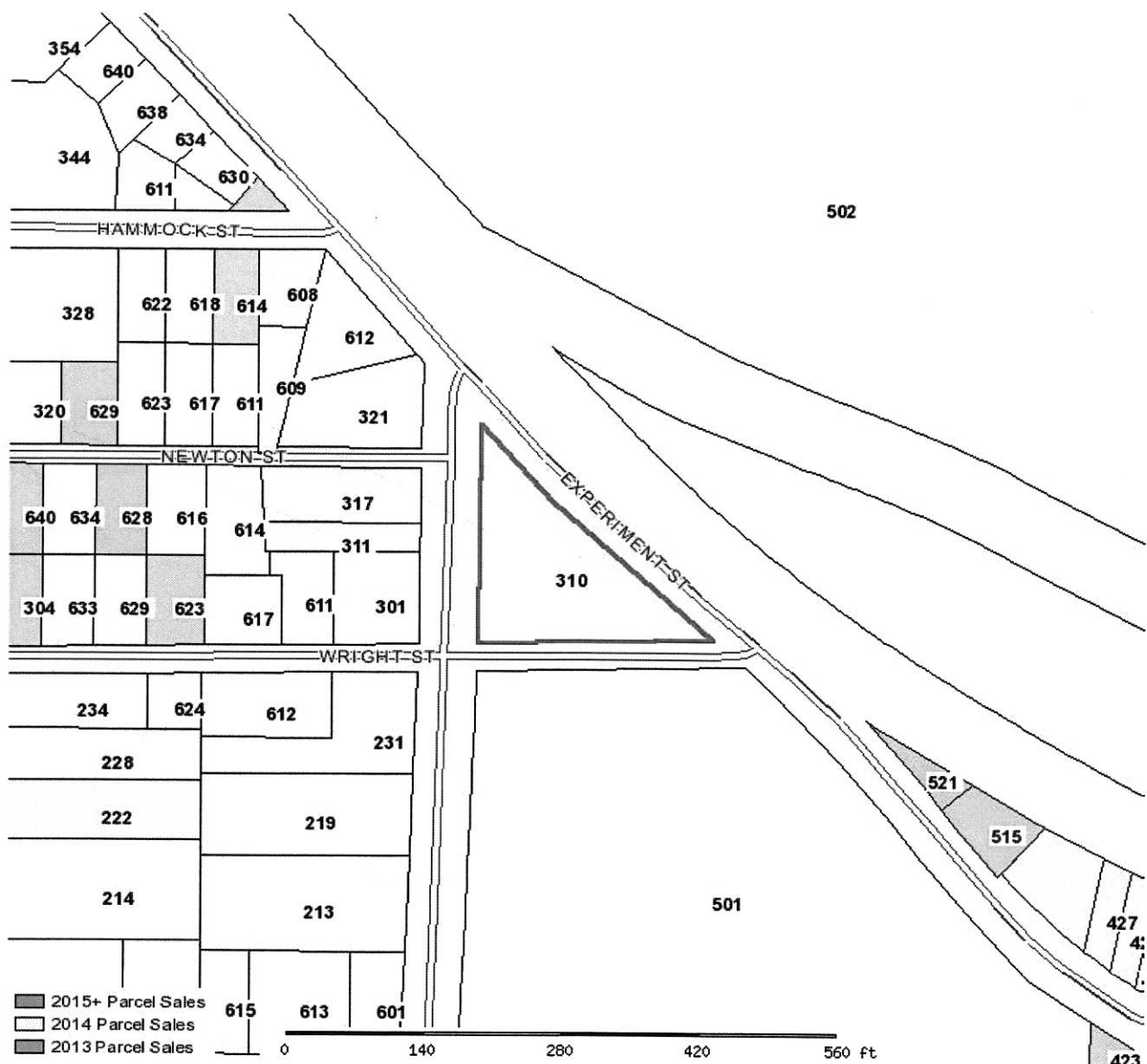

Spalding County Assessor

Parcel: 011 03001 Acres: 0.82

Name:	RAVEN GROUP LLC	Land Value	\$18,450.00
Site:	310 N 12TH ST	Building Value	\$10,303.00
Sale:	\$0 on 04-2006 Reason=XX Qual=U	Misc Value	\$2,190.00
Mail:	2341 PEACHWOOD CIR NE	Total Value:	\$30,943.00
	ATLANTA, GA 30345		

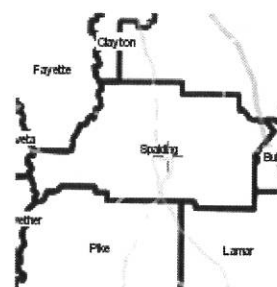

The Spalding County Assessor's Office makes every effort to produce the most accurate information possible. No warranties, expressed or implied, are provided for the data herein, its use or interpretation. The assessment information is from the last certified taxroll. All data is subject to change before the next certified taxroll. PLEASE NOTE THAT THE PROPERTY APPRAISER MAPS ARE FOR ASSESSMENT PURPOSES ONLY NEITHER SPALDING COUNTY NOR ITS EMPLOYEES ASSUME RESPONSIBILITY FOR ERRORS OR OMISSIONS ---THIS IS NOT A SURVEY---

Date printed: 03/02/16 : 13:48:11