







NO.	STATION	DESCRIPTION	DATE	REVISIONS	DATE	REVISIONS
1	100+00	START OF ROAD	5-2-13			
2	100+05	END OF ROAD	5-2-13			
3	100+10	START OF ROAD	5-2-13			
4	100+15	END OF ROAD	5-2-13			
5	100+20	START OF ROAD	5-2-13			
6	100+25	END OF ROAD	5-2-13			
7	100+30	START OF ROAD	5-2-13			
8	100+35	END OF ROAD	5-2-13			
9	100+40	START OF ROAD	5-2-13			
10	100+45	END OF ROAD	5-2-13			
11	100+50	START OF ROAD	5-2-13			
12	100+55	END OF ROAD	5-2-13			
13	100+60	START OF ROAD	5-2-13			
14	100+65	END OF ROAD	5-2-13			
15	100+70	START OF ROAD	5-2-13			
16	100+75	END OF ROAD	5-2-13			
17	100+80	START OF ROAD	5-2-13			
18	100+85	END OF ROAD	5-2-13			
19	100+90	START OF ROAD	5-2-13			
20	100+95	END OF ROAD	5-2-13			
21	101+00	START OF ROAD	5-2-13			
22	101+05	END OF ROAD	5-2-13			
23	101+10	START OF ROAD	5-2-13			
24	101+15	END OF ROAD	5-2-13			
25	101+20	START OF ROAD	5-2-13			
26	101+25	END OF ROAD	5-2-13			
27	101+30	START OF ROAD	5-2-13			
28	101+35	END OF ROAD	5-2-13			
29	101+40	START OF ROAD	5-2-13			
30	101+45	END OF ROAD	5-2-13			
31	101+50	START OF ROAD	5-2-13			
32	101+55	END OF ROAD	5-2-13			
33	101+60	START OF ROAD	5-2-13			
34	101+65	END OF ROAD	5-2-13			
35	101+70	START OF ROAD	5-2-13			
36	101+75	END OF ROAD	5-2-13			
37	101+80	START OF ROAD	5-2-13			
38	101+85	END OF ROAD	5-2-13			
39	101+90	START OF ROAD	5-2-13			
40	101+95	END OF ROAD	5-2-13			
41	102+00	START OF ROAD	5-2-13			
42	102+05	END OF ROAD	5-2-13			
43	102+10	START OF ROAD	5-2-13			
44	102+15	END OF ROAD	5-2-13			
45	102+20	START OF ROAD	5-2-13			
46	102+25	END OF ROAD	5-2-13			
47	102+30	START OF ROAD	5-2-13			
48	102+35	END OF ROAD	5-2-13			
49	102+40	START OF ROAD	5-2-13			
50	102+45	END OF ROAD	5-2-13			
51	102+50	START OF ROAD	5-2-13			
52	102+55	END OF ROAD	5-2-13			
53	102+60	START OF ROAD	5-2-13			
54	102+65	END OF ROAD	5-2-13			
55	102+70	START OF ROAD	5-2-13			
56	102+75	END OF ROAD	5-2-13			
57	102+80	START OF ROAD	5-2-13			
58	102+85	END OF ROAD	5-2-13			
59	102+90	START OF ROAD	5-2-13			
60	102+95	END OF ROAD	5-2-13			
61	103+00	START OF ROAD	5-2-13			
62	103+05	END OF ROAD	5-2-13			
63	103+10	START OF ROAD	5-2-13			
64	103+15	END OF ROAD	5-2-13			
65	103+20	START OF ROAD	5-2-13			
66	103+25	END OF ROAD	5-2-13			
67	103+30	START OF ROAD	5-2-13			
68	103+35	END OF ROAD	5-2-13			
69	103+40	START OF ROAD	5-2-13			
70	103+45	END OF ROAD	5-2-13			
71	103+50	START OF ROAD	5-2-13			
72	103+55	END OF ROAD	5-2-13			
73	103+60	START OF ROAD	5-2-13			
74	103+65	END OF ROAD	5-2-13			
75	103+70	START OF ROAD	5-2-13			
76	103+75	END OF ROAD	5-2-13			
77	103+80	START OF ROAD	5-2-13			
78	103+85	END OF ROAD	5-2-13			
79	103+90	START OF ROAD	5-2-13			
80	103+95	END OF ROAD	5-2-13			
81	104+00	START OF ROAD	5-2-13			
82	104+05	END OF ROAD	5-2-13			
83	104+10	START OF ROAD	5-2-13			
84	104+15	END OF ROAD	5-2-13			
85	104+20	START OF ROAD	5-2-13			
86	104+25	END OF ROAD	5-2-13			
87	104+30	START OF ROAD	5-2-13			
88	104+35	END OF ROAD	5-2-13			
89	104+40	START OF ROAD	5-2-13			
90	104+45	END OF ROAD	5-2-13			
91	104+50	START OF ROAD	5-2-13			
92	104+55	END OF ROAD	5-2-13			
93	104+60	START OF ROAD	5-2-13			
94	104+65	END OF ROAD	5-2-13			
95	104+70	START OF ROAD	5-2-13			
96	104+75	END OF ROAD	5-2-13			
97	104+80	START OF ROAD	5-2-13			
98	104+85	END OF ROAD	5-2-13			
99	104+90	START OF ROAD	5-2-13			
100	104+95	END OF ROAD	5-2-13			

PROJECT NO. 100-1005  
 SHEET NO. 10 OF 11  
 DATE 5-2-13

## **Exhibit "B"**

St. Georges Episcopal Church

1.12 +/- Acre Remnant Tract North Side of Broad/Experiment Streets

In consideration of the sale of the 1.12 +/- acre tract of land lying North of Broad/Experiment Streets between the rail road right of way the City of Griffin agrees to the following Special Provisions:

1. The officials of St. Georges Episcopal Church has the first right of refusal to purchase the property in the event the City of Griffin chooses to sell the property.
2. The City of Griffin agrees to maintain the land purchased primarily as green space.
3. The City of Griffin agrees that no trash dumpsters or porta-potties will ever be placed on the property purchased.
4. The City on Griffin agrees that no maintenance or storage facilities will be placed on the property purchased.

# AGREEMENT TO PURCHASE REAL ESTATE

Tax Parcel ID # 011 05011 Total Tract located at 423 West Broad Street. Griffin, Georgia

GEORGIA, SPALDING COUNTY

For and in consideration of the sum of One Dollar (\$1.00), receipt whereof being acknowledged, the undersigned grants to The CITY OF GRIFFIN an option to acquire the following described real estate:

All land and improvements and any other rights through that tract or parcel of land located in Land Lot 144 of the 2nd District, of Spalding County, Georgia, and being more particularly described on Exhibit "A" attached hereto and made a part hereof by reference.

For the sum of \$26,400.00, the undersigned agrees to execute and deliver to The City of Griffin fee simple title and easements to the lands owned by the undersigned as reflected on the attached Exhibit "A".

\* \* \* \* \*

The following conditions are imposed upon the grant of this option:

- 1) This option shall extend for 90 days from this day.
  - 2) The consideration recited is full payment for the rights conveyed.
  - 3) 0.077 +/- Acres of Land and all improvements located at 423 West Broad Street.
- Special Provisions, if any, are listed on Exhibit "B", which is attached hereto and incorporated herein by reference.  
( See attached special provision)

Witness my hand and seal this 17<sup>th</sup> day of November, 2011.

Signed, Sealed and Delivered  
in the presence of:

Tommy Thomas

Tommy Thomas (Seal)

Witness

Shirley C. Mobley  
Notary Public my Comm. Exp. 9-18-2016

\_\_\_\_\_  
(Seal)

## SPECIAL PROVISION:

CITY OF GRIFFIN TO ALLOW THE SELLER POSSESSION OF THE  
PROPERTY LESS THE EASEMENT NEEDED FOR STREET IMPROVEMENTS FOR  
A PERIOD OF 4 MONTHS FROM THE CLOSING DATE.

T.T

APPROVED BY Agne Mark

DATE 11/25/11

Tommy Thomas  
423 W. Broadway St.  
0 077 + 1/4 - AC.

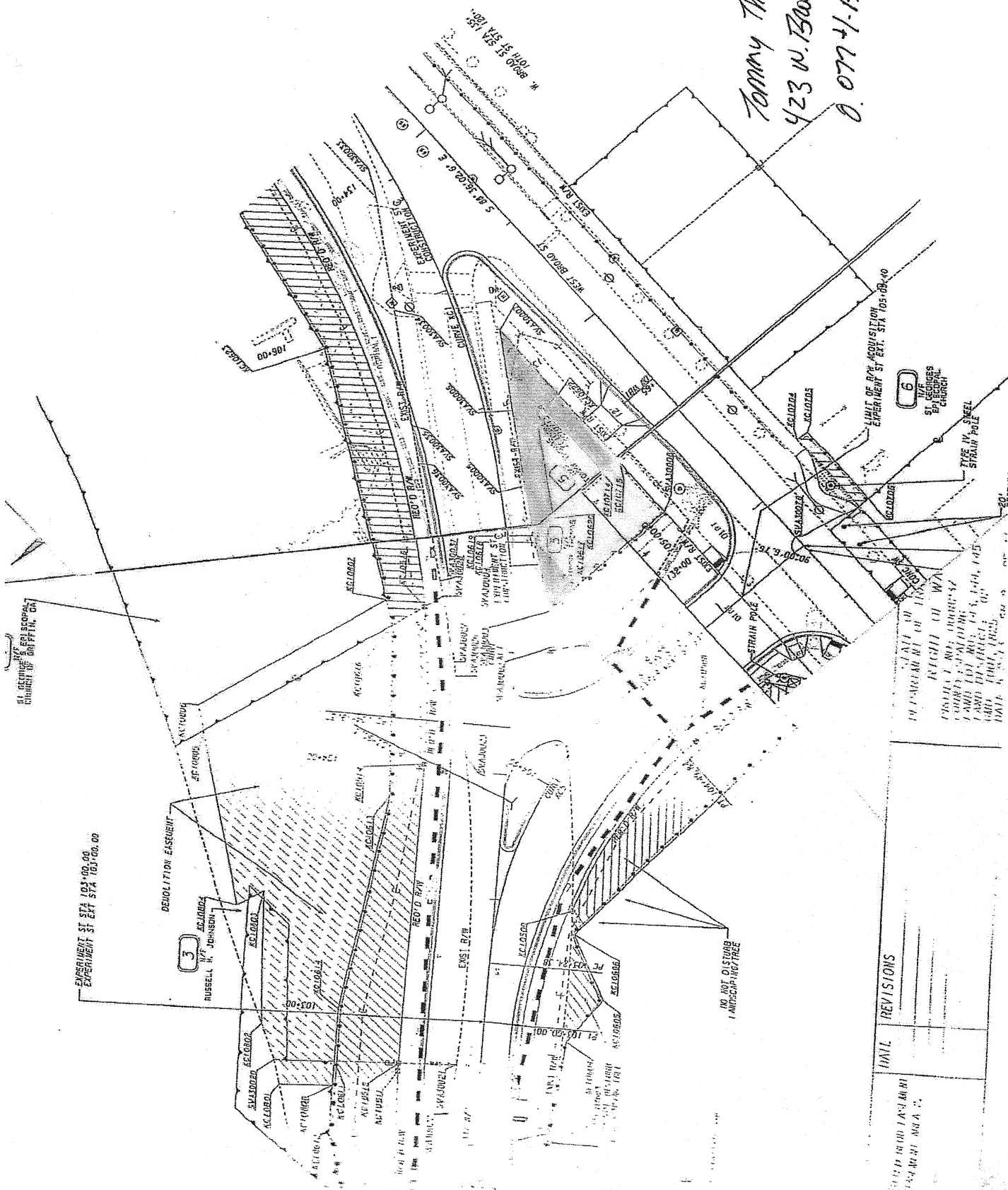
[illegible]

### **Exhibit "B"**

Tommy Thomas Tract located at 423 West Broad Street, Griffin, Georgia  
0.077 +/- Acre Tract with all improvements

In consideration of the sale of the 0.077 +/- acre tract of land and improvements the City of Griffin agrees to the following Special Provision:

1. The City agrees to allow the seller Tommy Thomas to remain in possession of the property ~~sixty (60)~~ <sup>(28)</sup> days after the date of the closing that conveys title to the property. This possession period is to be used to remove any and all items from the building located on the tract. The City will provide a letter advising the seller of the date to vacate the property at the closing.